

# NEW HIDE AWAY PACi

# Panasonic



## High Static Pressure Hide Away PACi Inverter+. High heating capacity at -7°C

The ducted systems are the ideal solution for flexible, concealed air conditioning and the optional 200mm spigots ensure simple, hassle-free connection to spiral ductwork.

**PACi**  
ELITE / STANDARD



### New wired remote controller with Econavi function control

Easy to use, attractive, clear design, with new demand control functions and energy consumption display! This useful feature makes this remote control unique!

The new CZ-RTC3 wired remote control is ideal for integration into the most demanding interior architectures.

The touch panel features a very sleek and easy to use display, which with its compact display is only 120mm x 120mm x 16mm.



### New Econavi Sensor

The all new Econavi Sensor detects presence in the room, and quietly adapts the PACi or VRF air conditioning system in order to improve comfort and maximise energy savings.

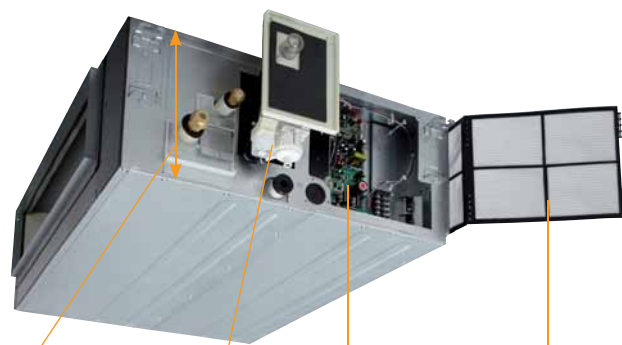

**Standardized height of 290 mm for all models**  
Height standardization enables easy and uniform installation for models with different capacities.

Built-in Drain pump (DC motor pump)

External electrical equipment box makes maintenance easy  
P-link PCB

- Built-in filter  
- Side removable filter

**SEASONAL EFFICIENCY (SCOP)**



### The static pressure outside the unit can be increased up to 150 Pa

Type	60	71	100	125	140
Standard	70 Pa	70 Pa	100 Pa	100 Pa	100 Pa
Max. available setting	150 Pa	150 Pa	150 Pa	150 Pa	150 Pa

### More powerful drain pump

Using a high-lift drain pump, drain piping can be elevated up to 785 mm from the base of the unit.

# HIGH STATIC PRESSURE HIDE AWAY PACi STANDARD AND ELITE INVERTER+

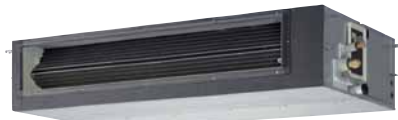
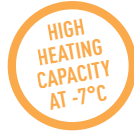

S-100PF1E5A // S-125PF1E5A // S-140PF1E5A

## OPTIONAL CONTROLLERS

Wired remote controller  
CZ-RTC3



Timer remote controller  
CZ-RTC2



Wireless remote controller  
CZ-RWSK2 + CZ-RWSC3



Simplified remote controller  
CZ-REXC2



Compatible with all Panasonic connectivity solutions. For detailed information go to the Control Systems section.



U-60PEY1E5 U-50PE1E5  
U-71PEY1E5



U-100PEY1E5 U-60PE1E5A  
U-125PEY1E5 U-71PE1E5A  
U-100PEY1E8 U-71PE1E5A  
U-125PEY1E8



U-140PEY1E8 U-100PE1E8A  
U-100PE1E5A U-125PE1E8A  
U-125PE1E5A U-140PE1E8A  
U-140PE1E5A

- Extremely quiet operation from 26 dB(A)
- Auto restart after power failure
- Auto changeover
- Twin, triple and double-twin split options
- DC FAN for better efficiency and control
- Built in drain pump
- Easy connection and control of external fan or ERV using the connector PAW-FDC on the indoor unit PCB. The external device can be control by the remote control of the Panasonic indoor unit

## Air inlet

The unit features air inlet on one side, air outlet on the other side. The air inlet filter can be pulled out from the side of the unit and can be folded. Easy access if through the maintenance opening. When air inlet duct (field supplied) is connected on suction side, remove the filter, frame and insulation materials on both sides of the unit. Connect the duct on the suction side of the unit by using prepared holes on the unit.

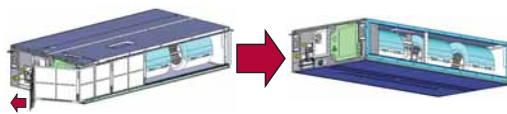

## Circle duct flange (option)

N. of exits with diameters	Model Code
2 x Ø 200	CZ-56DAF2 (2 SA outlet)
3 x Ø 200	CZ-90DAF2 (3 SA outlet)
4 x Ø 200	CZ-160DAF2 (4 SA outlet)



Control your air conditioning from wherever you are at home. Control your comfort and efficiency with the lowest energy consumption

Panasonic has always offered its customers the most efficient Heat Pumps and Air Conditioners. Now it has taken a step forward and presents a control solution taking advantage of the latest Cloud Technology to enable you to manage your climate system from anywhere in the world.

Control your environment from your smartphone, tablet computer, any Android device or from a PC with Internet access using this add-on service. Offering the same functions as if you were at home: start/stop, Mode Operation, Set Temperature, Room Temperature etc. Experience the new, advanced functionality provided by Panasonic to achieve the best comfort and efficiency with the lowest energy consumption.

HIGH STATIC PRESSURE HIDE AWAY PACi STANDARD AND ELITE INVERTER+	Cooling			Heating			Sound pressure <sup>3)</sup> Cool — Heat (Hi / Lo / S-Lo) dB(A)	Dimensions (In) H x W x D mm	Dimensions (Out) H x W x D mm	Operating range Cool — Heat Min / Max °C
	Capacity Nom (Min - Max) kW	ESEER Nominal W/W	Power input Nominal (Min - Max) kW	Capacity Nom (Min - Max) / at -7°C kW	SCOP Nominal W/W	Power input Nominal (Min - Max) kW				
<b>High Static Pressure Hide Away PACi Standard Inverter+</b>										
KIT-60PFY1E5A*	6,0 (2,0 - 7,0)	5,4 <b>A</b>	1,930 (0,325 - 2,850)	6,0 (1,8 - 7,0) / 4,39	3,8 <b>A</b>	1,410 (0,275 - 2,055)	35 / 32 / 26 - 35 / 32 / 26	290 x 1.000 x 700	569 x 790 x 285	-10 / +43 - -15 / +24
KIT-71PFY1E5A*	7,1 (2,0 - 7,7)	5,3 <b>A</b>	2,570 (0,325 - 3,270)	7,1 (1,8 - 8,1) / 4,32	3,8 <b>A</b>	1,800 (0,275 - 2,380)	35 / 32 / 26 - 35 / 32 / 26	290 x 1.000 x 700	569 x 790 x 285	-10 / +43 - -15 / +24
KIT-100PFY1E5A*	10,0 (2,7 - 11,5)	5,4 <b>A</b>	3,320 (0,530 - 4,200)	10,0 (2,1 - 13,8) / 7,22	3,8 <b>A</b>	2,630 (0,410 - 4,000)	38 / 34 / 31 - 38 / 34 / 31	290 x 1.000 x 700	996 x 940 x 340	-10 / +43 - -15 / +24
KIT-125PFY1E5A*	12,5 (3,8 - 13,5)	3,7 <sup>1)</sup>	4,100 (0,900 - 5,000)	12,5 (3,4 - 15,0) / 9,14	3,8 <sup>2)</sup>	3,270 (0,730 - 4,400)	39 / 35 / 32 - 39 / 35 / 32	290 x 1.000 x 700	996 x 940 x 340	-10 / +43 - -15 / +24
KIT-100PFY1E8A*	10,0 (2,7 - 11,5)	5,2 <b>A</b>	3,320 (0,530 - 4,200)	10,0 (2,1 - 13,8) / 7,22	3,8 <b>A</b>	2,630 (0,410 - 4,000)	38 / 34 / 31 - 38 / 34 / 31	290 x 1.000 x 700	996 x 940 x 340	-10 / +43 - -15 / +24
KIT-125PFY1E8A*	12,5 (3,8 - 13,5)	3,7 <sup>1)</sup>	4,100 (0,900 - 5,000)	12,5 (3,4 - 15,0) / 9,14	3,4 <sup>2)</sup>	3,270 (0,730 - 4,400)	39 / 35 / 32 - 39 / 35 / 32	290 x 1.000 x 700	996 x 940 x 340	-10 / +43 - -15 / +24
KIT-140PFY1E8A*	14,0 (3,3 - 15,5)	3,8 <sup>1)</sup>	4,350 (0,840 - 6,000)	14,0 (4,1 - 16,0) / 11,68	3,5 <sup>2)</sup>	3,580 (0,900 - 5,200)	40 / 36 / 33 - 40 / 36 / 33	290 x 1.000 x 700	1.416 x 940 x 340	-10 / +43 - -15 / +24
<b>High Static Pressure Hide Away PACi Elite Inverter+</b>										
KIT-50PF1E5A*	5,0 (1,5 - 5,6)	5,7 <b>A+</b>	1,350 (0,260 - 2,000)	5,6 (1,5 - 6,5) / 3,62	3,8 <b>A</b>	1,500 (0,220 - 2,400)	34 / 30 / 26 - 34 / 30 / 26	290 x 800 x 700	569 x 790 x 285	-15 / +46 - -20 / +24
KIT-60PF1E5A*	6,0 (2,5 - 7,1)	6,4 <b>A++</b>	1,540 (0,530 - 2,000)	7,0 (2,0 - 8,0) / 5,85	3,9 <b>A</b>	1,810 (0,480 - 2,480)	35 / 32 / 26 - 35 / 32 / 26	290 x 1.000 x 700	996 x 940 x 340	-15 / +46 - -20 / +24
KIT-71PF1E5A*	7,1 (2,5 - 8,0)	6,4 <b>A++</b>	1,850 (0,530 - 2,650)	8,0 (2,0 - 9,0) / 6,69	4,0 <b>A+</b>	2,080 (0,480 - 2,900)	35 / 32 / 26 - 35 / 32 / 26	290 x 1.000 x 700	996 x 940 x 340	-15 / +46 - -20 / +24
KIT-100PF1E5A*	10,0 (3,3 - 12,5)	5,8 <b>A+</b>	2,440 (0,840 - 3,700)	11,2 (4,1 - 14,0) / 9,63	3,8 <b>A</b>	2,600 (0,900 - 4,400)	38 / 34 / 31 - 38 / 34 / 31	290 x 1.400 x 700	1.416 x 940 x 340	-15 / +46 - -20 / +24
KIT-125PF1E5A*	12,5 (3,3 - 14,0)	4,3 <sup>1)</sup>	3,570 (0,840 - 4,600)	14,0 (4,1 - 16,0) / 11,80	3,6 <sup>2)</sup>	3,480 (0,900 - 5,200)	39 / 35 / 32 - 39 / 35 / 32	290 x 1.400 x 700	1.416 x 940 x 340	-15 / +46 - -20 / +24
KIT-140PF1E5A*	14,0 (3,3 - 15,5)	3,8 <sup>1)</sup>	4,310 (0,840 - 6,000)	16,0 (4,1 - 18,0) / 13,98	3,4 <sup>2)</sup>	4,440 (0,900 - 5,900)	40 / 36 / 33 - 40 / 36 / 33	290 x 1.400 x 700	1.416 x 940 x 340	-15 / +46 - -20 / +24
KIT-71PF1E8A*	7,1 (3,2 - 8,0)	5,2 <b>A</b>	1,850 (0,640 - 2,650)	8,0 (2,8 - 9,0) / 6,69	3,7 <b>A</b>	2,080 (0,580 - 2,900)	35 / 32 / 26 - 35 / 32 / 26	290 x 1.000 x 700	996 x 940 x 340	-15 / +46 - -20 / +24
KIT-100PF1E8A*	10,0 (3,3 - 12,5)	5,8 <b>A+</b>	2,440 (0,840 - 3,700)	11,2 (4,1 - 14,0) / 9,63	3,8 <b>A</b>	2,600 (0,900 - 4,400)	38 / 34 / 31 - 38 / 34 / 31	290 x 1.400 x 700	1.416 x 940 x 340	-15 / +46 - -20 / +24
KIT-125PF1E8A*	12,5 (3,3 - 14,0)	4,3 <sup>1)</sup>	3,570 (0,840 - 4,600)	14,0 (4,1 - 16,0) / 11,80	3,6 <sup>2)</sup>	3,480 (0,900 - 5,200)	39 / 35 / 32 - 39 / 35 / 32	290 x 1.400 x 700	1.416 x 940 x 340	-15 / +46 - -20 / +24
KIT-140PF1E8A*	14,0 (3,3 - 15,5)	3,8 <sup>1)</sup>	4,310 (0,840 - 6,000)	16,0 (4,1 - 18,0) / 13,98	3,4 <sup>2)</sup>	4,440 (0,900 - 5,900)	40 / 36 / 33 - 40 / 36 / 33	290 x 1.400 x 700	1.416 x 940 x 340	-15 / +46 - -20 / +24

Rating Conditions: Cooling Indoor 27°C DB / 19°C WB. Cooling Outdoor 35°C DB / 24°C WB. Heating Indoor 20°C DB. Heating Outdoor 7°C DB / 6°C WB. (DB: Dry Bulb; WB: Wet Bulb). // Specifications subject to change without notice.

1) ESEER is calculated in base Eurovent IPLV for SBEM for U1 indoor unit SEER=a(EER25)+b(EER25)+c(EER75)+d(EER100) where EER25, EER50, EER75 and EER100 are the EER measured value at 25%, 50%, 75% and 100% part load for temperatures 20, 25, 30 and 35°C DB, respectively. a, b, c and d are values assigned for an office type. These values are given as a=0,2, b=0,36, c=0,32 and d=0,03. The internal temperatures are taken at 27°C DB and 19°C WB. 2) SCOP is calculated in base Eurovent IPLV for SBEM with U1 indoor unit including defrost correction factor. 3) The Sound pressure level of the units shows the value measured of a position 1 meter in front of the main body and 1,5 m from the ground. The sound pressure is measured in accordance with Eurovent 6/C/006-97 specification.

\* Available from May 2014.

For detailed information about ErP, please visit our page <http://www.ptc.panasonic.eu>



Internet Control is a next generation system providing a user-friendly remote control of air conditioning or heat pump units from everywhere, using a simple Android or iOS smartphone, tablet or PC via internet.



Inverter+ products improve on the characteristics of standard Inverter range by over 20%. This means 20% less consumption and 20% off your electric bill. A Inverter plus is also A class on cooling and heating mode.



Exceptional Seasonal Cooling Efficiency based on the new ErP regulation. Higher the SEER ratings mean greater efficiency. Save all the year while cooling! For KIT-71PF1E5A.



Exceptional Seasonal Heating Efficiency based on the new ErP regulation. Higher the SCOP ratings mean greater efficiency. Save all the year while heating! For KIT-71PF1E5A.



The air conditioner works in cooling only mode with an outdoor temperature of -15°C. For Elite range.



The air conditioner works in heat pump mode even when outdoor temperatures are as low as low as -20°C. For Elite range.



The communication port is integrated into the indoor unit and provides easy connection to, and control of, your Panasonic heat pump to your home or building management system.



The Panasonic renewal system allows good quality existing R22 pipe work to be re-used whilst installing new high efficiency R410A systems.



We guarantee the entire compressors in the entire range for five years.

# Panasonic

To find out how Panasonic cares for you, log on to: [www.aircon.panasonic.eu](http://www.aircon.panasonic.eu)

Panasonic Marketing Europe GmbH  
Panasonic Air Conditioning  
Hagenauer Strasse 43, 65203 Wiesbaden, Germany

heatingandcoolingsystems



**Inoterma UAB**  
S.Neries g.24-39  
LT-06009 Vilnius  
+37064102602  
[www.inoterma.lt](http://www.inoterma.lt)  
[info@inoterma.lt](mailto:info@inoterma.lt)